

No. 2

Capacity: 1/8" - 2"

No. 3

Capacity: 3/8" - 3"

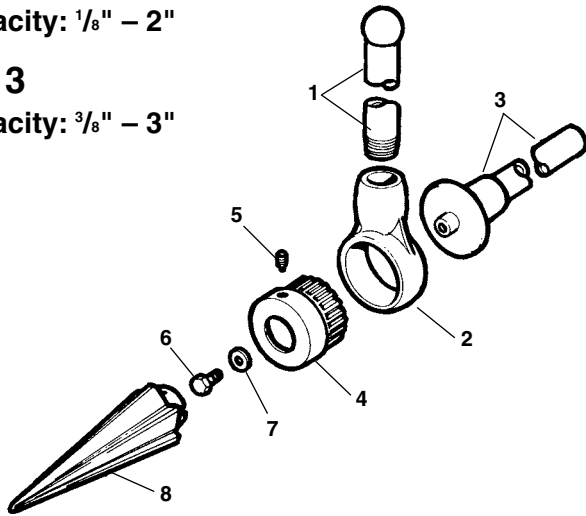

No. 2-S

Capacity: 1/8" - 2"

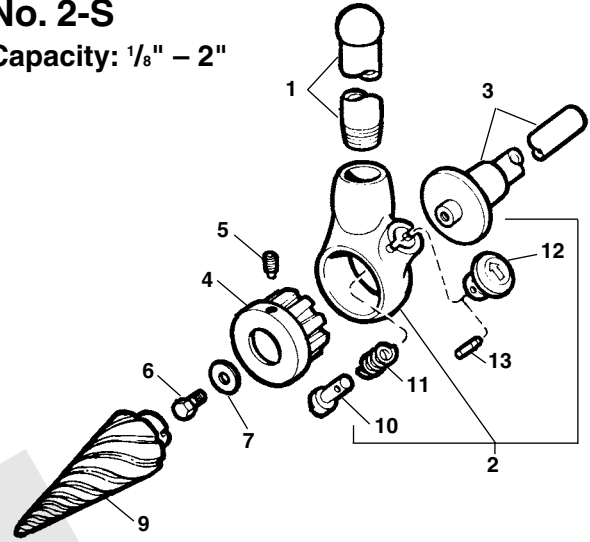

**NOTE: Order parts by Catalog Number only.
DO NOT order by Reference Number.**

| Ref. No. | Description | No. 2 Catalog No. | No. 3 Catalog No. | No. 2-S Catalog No. |
|----------|----------------------------------|----------------------|----------------------|------------------------|
| — | Reamer Assembly Complete | 34945 | 35950 | 34955 |
| 1 | Handle | 35030 | 35030 | 35030 |
| 2 | Ratchet Assembly w/Pawl & Spring | 34980 | 35100 | 35065 |
| 3 | Handgrip | 34985 | 35115 | 35070 |
| 4 | Ratchet Head | 34990 | 35105 | 35040 |
| 5 | Set Screw | 35045 | 35045 | 35045 |
| 6 | Screw | 35050 | 35050 | 35050 |
| 7 | Washer | 35055 | 35055 | 35055 |
| 8 | Straight Reamer Cone | 34975 | 35090 | — |
| 9 | Spiral Reamer Cone | — | — | 35020 |
| 10 | Pawl | — | — | 38690 |
| 11 | Spring | — | — | 38695 |
| 12 | Knob | — | — | 38700 |
| 13 | Pin | — | — | 38705 |

No. 254

Capacity: 2 1/2" - 4"

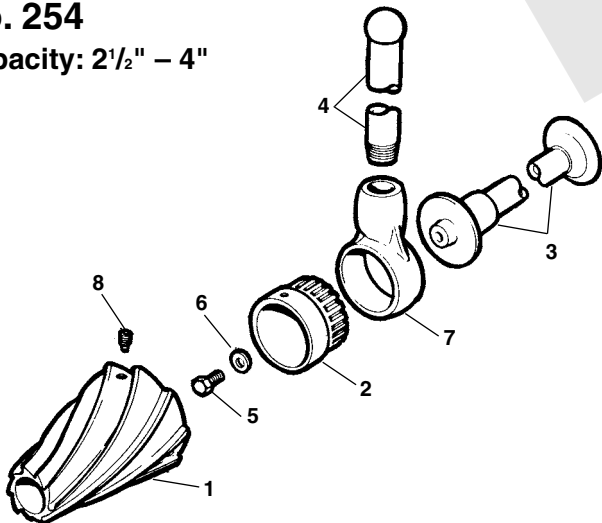

| Ref. No. | Catalog No. | Description |
|----------|-------------|----------------------------------|
| — | 34960 | 254 Reamer |
| 1 | 35135 | Spiral Reamer Cone |
| 2 | 35145 | Ratchet Head |
| 3 | 35150 | Handgrip Assembly |
| 4 | 35030 | Handle |
| 5 | 35050 | Screw |
| 6 | 35055 | Washer |
| 7 | 35100 | Ratchet Assembly w/Pawl & Spring |
| 8 | 35140 | Set Screw (3) |